

PLANT EVALUATION REPORT



Report# C-1808221

Continent
Inspection Service Co., Ltd.

Applicant	:	Premise	Manufacturer	:	Shenzhen Ruidisi Lighting Co.,Ltd
Attention	:		Contact Person	:	Linda
Telephone	:		Address	:	2 nd F, Block 3, RiHai Hi-Tech Industry park, Da Ken Road, TongLe community, Long Gang district, ShenZhen City.
Fax	:		Telephone	:	+86 13723769607 +86-755-28909523
E-mail	:		Fax	:	+86-755-89787710
Date	:		Auditors	:	Andy

Stage : ☒ [V] Initial Evaluation ☐ [] Re-evaluation (Last report No.:)
☐ [] Follow-up Evaluation ☐ [] Others

Audit rule : ISO9000/90001,ISO14000,COC and industry general standard

Participators from the factory:

Name	Department	Position	Name	Department	Position
Jackie	GM office	GM	Koy	QC	Manager
Ali	GM office	Vice GM	Tom	Production	Sectopm Chief
Linda	Sales	Manager	Mali	R&D	Manager

RESULTS:

* <u>Audit criteria</u>		Score	Highest Score	Percent	Grade
Part 0	General Information				
Part 1	Infrastructure and production machines	29	35	83%	B
Part 2	Production process control	31	40	78%	C
Part 3	Packing, handling and storage	26	30	87%	B
Part 4	Training, knowledge, skill, and experience	24	30	80%	B
Part 5	Inspection/testing and quality control	40	50	80%	B
Part 6	Documentation of management / records control	25	30	83%	B
Part 7	Managers in high-level	23	30	77%	C
OVERALL CONCLUSION (GRADE)		C			
REMARK					

Note:	Scoring: A=Outstanding=5 B=Good = 4 C=Acceptable =3 D=Below requirement=1 E=Absent or Not-available=0
-------	---

PLANT EVALUATION REPORT



Continent

Inspection Service Co., Ltd.

Report# C-1808221

Summarize to the findings

Shenzhen Ruidisi Lighting Co., Ltd (Brand is RDS) was founded on 2012-07-16. It is an integrated Hi-tech enterprise which specializes in lighting design, product application and supply, focus on managing products from concept to completion.

Factory is located in ShenZhen City, China. Covering around 2000 m², it has 93 employees, including R&D department. It's main products are LED high bay light, led troffer light, led linear high bay light, led strip fixture light, led strip retrofit kits and led flood light. Products are sold to Europe, America, Australia, New Zealand, Middle East and other countries. The products series are certified by institution tests such as FCC, SAA, C-Tick, CE and RoHS.

Attachments:

Remark 1: The factory address difference was found among in business license, official website and actual audit location.

1. Actual audit address: 2nd F, Block 3, RiHai Hi-Tech Industry park, Da Ken Road, TongLe community, Long Gang district, ShenZhen City.
2. Business License address: A#2F, No.2 ZhangBeiChuangYe Road, XinLian community, LongCheng Street, Long Gang district, ShenZhen City.
3. Official website address: No. 272, AiNan Road, AiLian Town, Long Gang district, ShenZhen City.

Remark 2: During audit, the manufacturer only provided LED Chip supplier certificate copy, supply record for reference.

Follow up suggestions:

1. Factory should identify semi-finished goods with model name, production date, quality status at least. All semi-finished parts need, including in production workshop.
2. Factory should get the copy of regulations kept in factory for study & reference.

PLANT EVALUATION REPORT



Report# C-1808221

Continent
Inspection Service Co., Ltd.

PART 0 GENERAL INFORMATION

0.1 Manpower

Staff	Total number	Percentage	Staff	Total number	Percentage
Manager	9	10%	Technical personnel	8	9%
Q.C	6	6%	Workers	70	75%
Others	-	-	Total number of staff	93	100%

0.2 Production planning per day:

☒ One shift: 8 hours / per shift ☐ Two shifts: _____ hours / per shift ☐ Three shifts: _____ hours / per shift

0.3 Production capability

Product	History of Production (Year)	History of export (Year)	Output per month (pcs)
LED high bay light	2012	2012	2500~9000
LED flood light	2012	2012	2000~8000
LED street light	2012	2012	1500~6000
LED down light	2012	2012	2000~10000
LED tube light	2014	2014	3500~15000
LED panel light	2014	2014	2500~8000
LED UFO light	2015	2015	350~1750
LED Tri-proof	2016	2016	1000~3000
LED Stadium	2017	2017	300~1500
LED strip fixture light	2017	2017	3000~5000
LED barn light	2017	2017	800~3000
LED troffer light	2017	2017	400~2000

0.4 Production area and workshops

☒ Only one production area ☐ total _____ production area, details:

Location1: _____

Location2: _____

0.5 Technical capability of production

☒ Produce the products ☐ Assemble the products ☐ Subcontract the order to other factory

PLANT EVALUATION REPORT



Report# C-1808221

Continent
Inspection Service Co., Ltd.

0.6 Main production machines/equipments

Machine name	Numbers	Machine name	Numbers	Machine name	Numbers
SMT machine	1	Auto aging machine	1	Aging rack	4
Laser engraving machine	2	Reflow soldering machine	1	Temperature monitor	3
Hi-Pot test	3	Air compressor	1	Electric parameter detector	4

PART 1 Infrastructure and production machines

No.	Check and evaluation point	Grade
1.1	Is the layout/ buildings of the factory /workshop/warehouse reasonable and benefiting the production?	B
1.2	Does there exist some pollutants like soot, dirt, acid mist and etc. around the factory /workshop/warehouse that affect the production?	B
1.3	Are the workshop/ production lines maintained cleanliness, tidiness and suitable for the production?	B
1.4	Are electronic communicated apparatus such as telephone, fax and other office apparatus such as computer, copycat available in the factory?	A
1.5	Does the factory have adequate kinds/quantities of machines/equipment/fixtures for the production of intended products?	B
1.6	Does the factory maintain the machines/equipment/fixtures regularly to ensure their continuing process capability?	B
1.7	Based on observation on-site, are the machines/equipment/fixtures in a good condition?	B

PART 2 Production process control

No.	Check and evaluation point	Grade
2.1	Does the factory adopt a proper way to make on-the-spot workers understand the	B

PLANT EVALUATION REPORT



Report# C-1808221

Continent
Inspection Service Co., Ltd.

	concrete requirements of orders/ plans and the amendments of production?	
2.2	Does the factory formulate operating instructions for key working process and issue them to related workstations?	B
2.3	Do the operating instructions correctly stipulate the process parameters, product characteristics and workmanship criteria?	B
2.4	Does the factory adopt adequate ways to monitor and control the suitable parameters and product characteristics on key process?	B
2.5	Base on observation on the spot, do workers operate correctly and meet the requirement in the production process?	B
2.6	Are those raw materials, semi-finished products, finished products in workshop arrayed/stock in good order and carefully protected to avoid confused or damaged?	B
2.7	Does the factory adopt a suitable way such as marking, labeling and etc. to identify the raw materials/semi-finished products/finish products to avoid confusion?	B
2.8	Does the factory adopt a suitable way such as marking, labeling and etc. to identify the raw materials/semi-finished products/finish products/samples for specified client to avoid it confusion with other clients?	C

PART 3 Packing, handling and storage

No.	Check and evaluation point	Grade
3.1	Does the factory use adequate method/material to pack the products to ensure conformance with specified requirements?	A
3.2	Does the factory use proper methods/containers/utensils for handling and delivery of product to prevent damage or deterioration?	A
3.3	Are the warehouses keeping clean, bulk goods piled up suitably?	B
3.4	Does the factory adopt appropriate methods to prevent the stored goods from improper pressing, crashing, sun burning, leaking, mildewing or insects bite?	B
3.5	Does the factory adopt a suitable way such as making, labeling, and etc. to identify stored goods especially for specified client's goods to avoid confusion?	B
3.6	Does the factory have an appropriate system or methods for controlling receipt and dispatching from stock area?	B

PLANT EVALUATION REPORT



Report# C-1808221

Continent
Inspection Service Co., Ltd.

PART 4 Training, knowledge, skill, and experience

No.	Check and evaluation point	Grade
4.1	Does the factory exist and implement training procedures / plans to train personnel performing activities affecting quality?	B
4.2	Base on observation or exam on-spot, are those workers well-trained and skillful for the assigned work?	B
4.3	Are the workers with good attitude regarding to production, quality requirements, inspections and re-work action?	B
4.4	Has the factory ever provided enough courses of product standard and inspection/testing to the Q.C/inspectors?	B
4.5	Base on observation or exam on-spot , does those Q.C/inspectors have suitable knowledge/ability/skill to meet the requirements for their assigned work?	B
4.6	Are the leader of Q.C department, managers of workshop with good attitude regarding to the 2 nd and 3 rd party's inspection or audit?	B

PART 5 Inspection/testing and quality control

No.	Check and evaluation point	Grade
5.1	Does the factory carry out receiving inspection/testing process when receiving or before using the purchased materials and subcontracted product?	B
5.2	Does the factory set up adequate number of inspect/testing stations on suitable process of production to ensure that the quality of product conformed to the specified requirement before being released?	B
5.3	Does the factory designate an adequate number of inspectors to perform the in-process inspection and testing?	B
5.4	Does the factory carry out the final inspection for all batches of products in accordance with the final inspection standard?	B
5.5	Does the factory formulate the final-inspection standard for all products? Are all related parameters/characteristic/criteria and inspection methods stipulated on the standard?	B
5.6	Does the factory ensure that only when the result of final inspection meet specified	B

PLANT EVALUATION REPORT



Report# C-1808221

Continent
Inspection Service Co., Ltd.

	requirement or standard, the product can be released?	
5.7	Does the factory equipped with adequate types and quantities of inspection and testing equipments/ apparatus for final inspection?	B
5.8	Are the inspection/ measuring and test equipments used for final-inspection calibrated and well maintained?	B
5.9	When finding nonconforming product, does the factory identify and segregate them immediately?	B
5.10	Does the factory carry out re-inspection/testing for all reworked and repaired products?	B

PART 6 Documentation of management / records control

No.	Check and evaluation point	Grade
6.1	Does the factory has document such as management manual to describe the quality management system?	B
6.2	Dose the factory has document to define the responsibility, authority of the personnel who manage, perform and verify work affecting quality?	A
6.3	Does the factory has established and documented min management procedures which affecting quality strictly?	B
6.4	Does the factory have procedure for collecting, filling, storage, maintenance and etc of product quality records?	B
6.5	Does the factory preserve related quality records (especially final inspection records, , calibration of testing equipment records) in an adequate period?	B
6.6	Are the data and information recorded in those quality records clear, integrated, veracious and signed by related recorder?	B

PART 7 Managers in high-level

No.	Check and evaluation point	Grade
7.1	What about the knowledge, experience and ability of the managers in high-level	B
7.2	What is the attitude of the managers in high-level for client's requirement, inspection,	B

PLANT EVALUATION REPORT



Report# C-1808221

Continent
Inspection Service Co., Ltd.

	quality, nonconforming product and corrective action?	
7.3	What is the attitude of the managers in high-level for this audit?	B
7.4	Does the factory respond the customer's complaint in time and deal with it correctly?	B
7.5	When problems on trade appear, is the factory willing to undertake their relevant responsibility?	B
7.6	When the customers require compensation, is the factory willing to indemnify the client's lost?	C

PLANT EVALUATION REPORT



Report# C-1808221

Continent
Inspection Service Co., Ltd.

PHOTO ATTACHMENT

1 Factory information



1 Factory location



2 Factory location



3 Factory address



4 Industry park door



PLANT EVALUATION REPORT



Report# C-1808221

Continent
Inspection Service Co., Ltd.

5 Factory building view

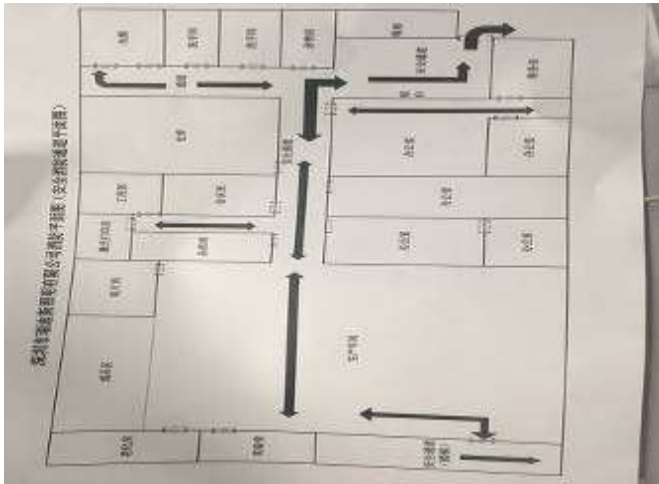

6 Factory building view

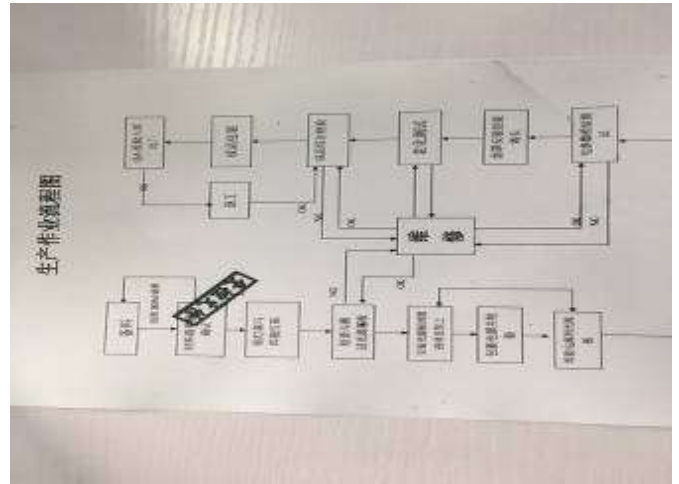

7 Factor layout



8 Production flow chart



9 Business license

10 Business license duplicate



11 Business Licence representative

12 Business Licence representative

PLANT EVALUATION REPORT



Report# C-1808221

Continent
Inspection Service Co., Ltd.

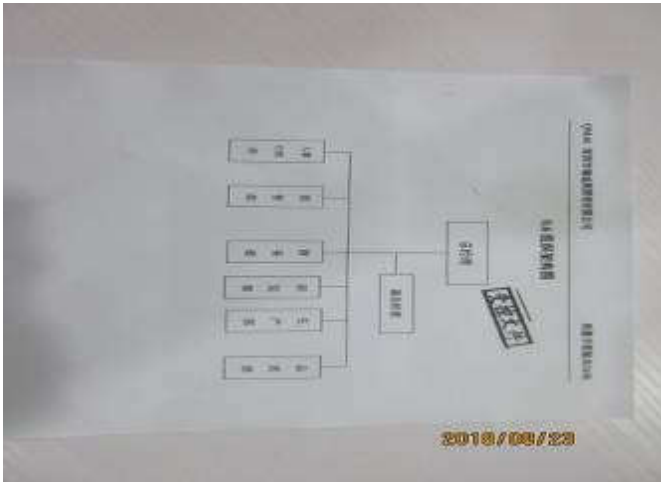

13 Organization chart



14 Trade mark registration

15 Machine & Equipment list

16 Machine & Equipment list

17 Machine & Equipment list



18 Organization

PLANT EVALUATION REPORT



Report# C-1808221

Continent
Inspection Service Co., Ltd.

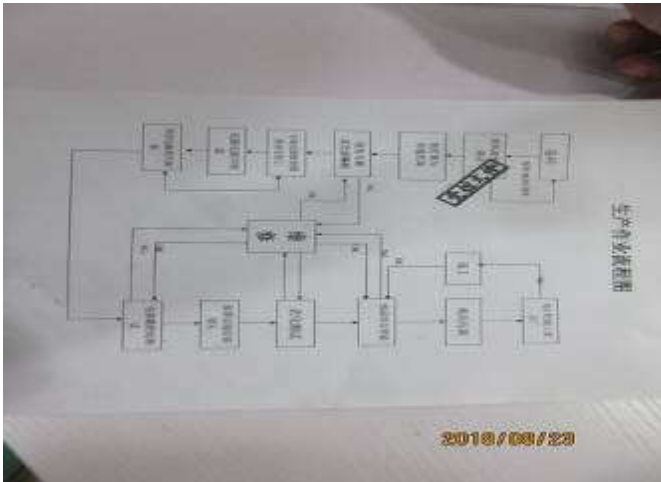

19 Production flow chart

2 Factory view

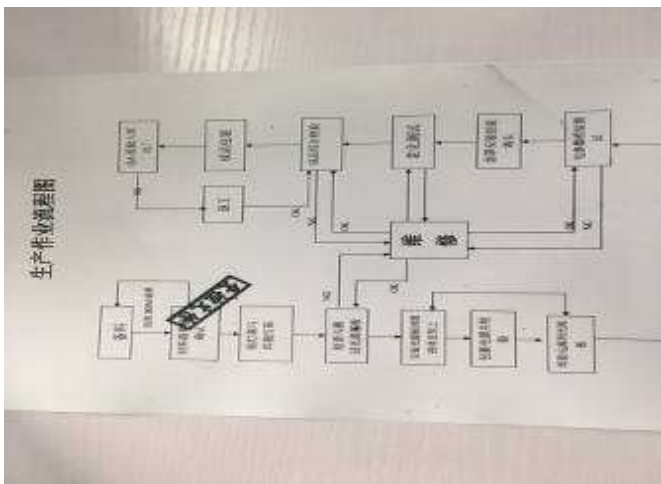

1 Production flow chart

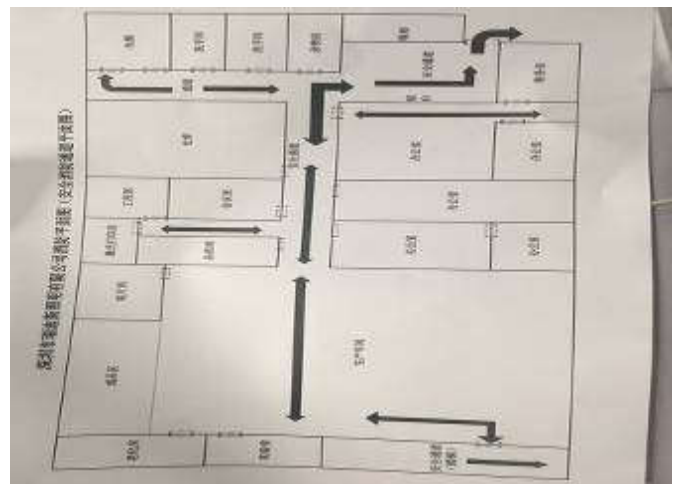

2 Factor layout- 3 floor



3 Factory building view



4 Factory building view

PLANT EVALUATION REPORT



Report# C-1808221

Continent
Inspection Service Co., Ltd.



5 Locate second floor



6 Locate second floor



7 Locate second floor



8 Locate second floor



9 Locate second floor



10 Locate second floor

PLANT EVALUATION REPORT



Report# C-1808221

Continent
Inspection Service Co., Ltd.



11 Locate second floor



12 Locate second floor



13 Visitor receive



14 Department office



15 Department office



16 Department office

PLANT EVALUATION REPORT



Report# C-1808221

Continent
Inspection Service Co., Ltd.



17 BBS



18 GM office



18 BBS



19 GM office



20 GM office



21 GM office

PLANT EVALUATION REPORT



Report# C-1808221

Continent
Inspection Service Co., Ltd.



22 Director office



23 Vice GM office



24 Vice GM office



25 Manage office



26 Manage office



27 Manage office

PLANT EVALUATION REPORT



Report# C-1808221

Continent
Inspection Service Co., Ltd.



28 Manage office



29 Finance office



30 Finance office



31 Sales office



32 Sales office



33 Sales office

PLANT EVALUATION REPORT



Report# C-1808221

Continent
Inspection Service Co., Ltd.



34 Sales office

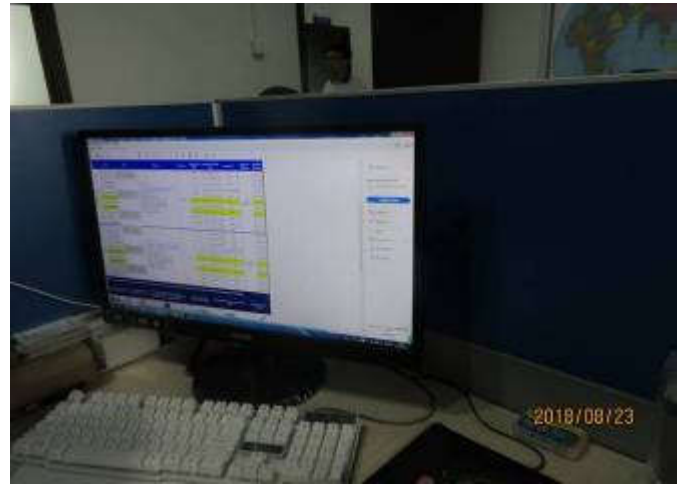

35 Sales office



36 Show room and meeting office



37 Show room and meeting office



38 Show room and meeting office



39 Show room and meeting office

PLANT EVALUATION REPORT



Report# C-1808221

Continent
Inspection Service Co., Ltd.



40 Show room and meeting office



41 Show room and meeting office



42 Show room and meeting office



43 Show room and meeting office



44 Show room and meeting office



45 Show room and meeting office

PLANT EVALUATION REPORT



Report# C-1808221

Continent
Inspection Service Co., Ltd.



46 Show room and meeting office



47 Show room and meeting office



48 Show room and meeting office



49 Show room and meeting office



50 R&D department



51 R&D department

PLANT EVALUATION REPORT



Report# C-1808221

Continent
Inspection Service Co., Ltd.

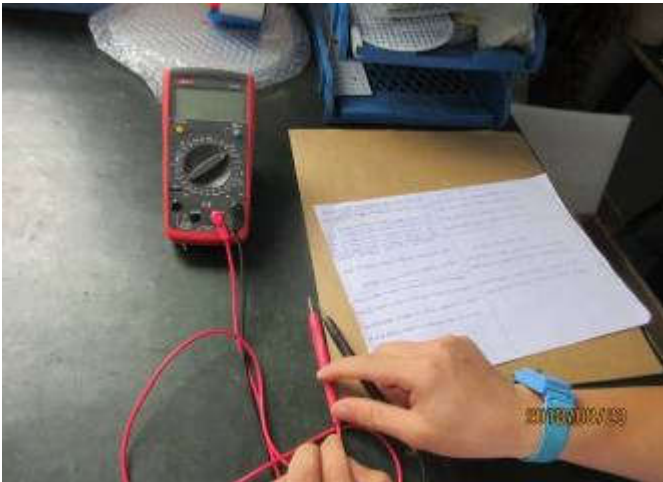

52 R&D department



53 R&D department

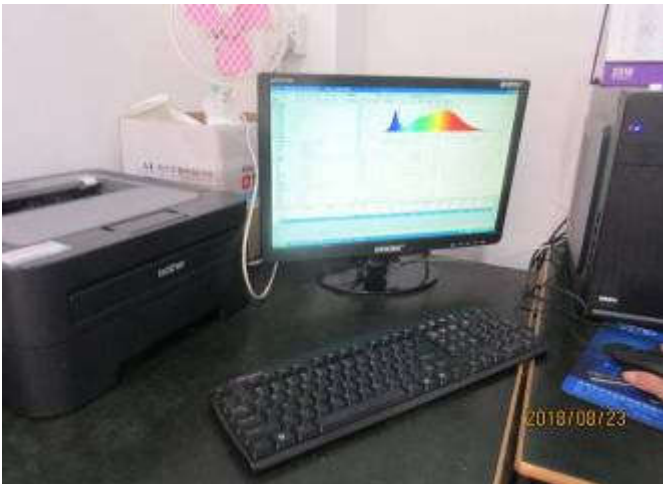

54 R&D department



55 R&D department



56 R&D department



57 R&D department

PLANT EVALUATION REPORT



Report# C-1808221

Continent
Inspection Service Co., Ltd.



58 R&D department

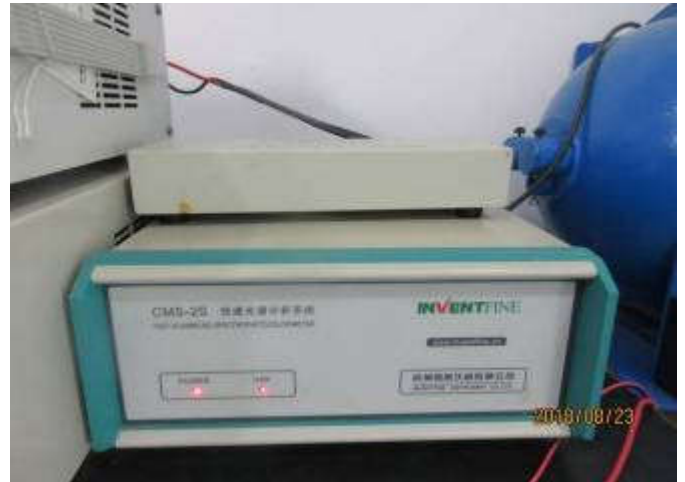

59 R&D department



60 R&D department



61 R&D department



62 R&D department

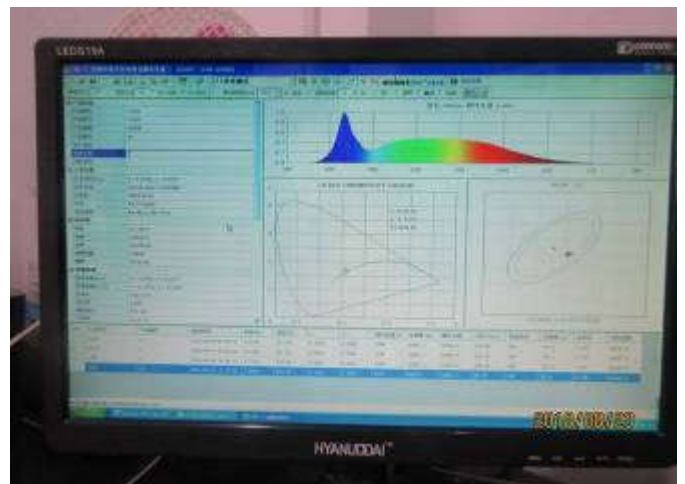

63 R&D department

PLANT EVALUATION REPORT



Report# C-1808221

Continent
Inspection Service Co., Ltd.

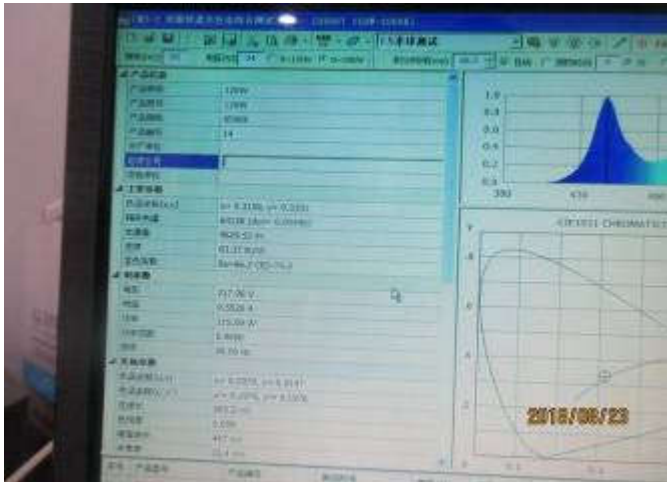

64 R&D department

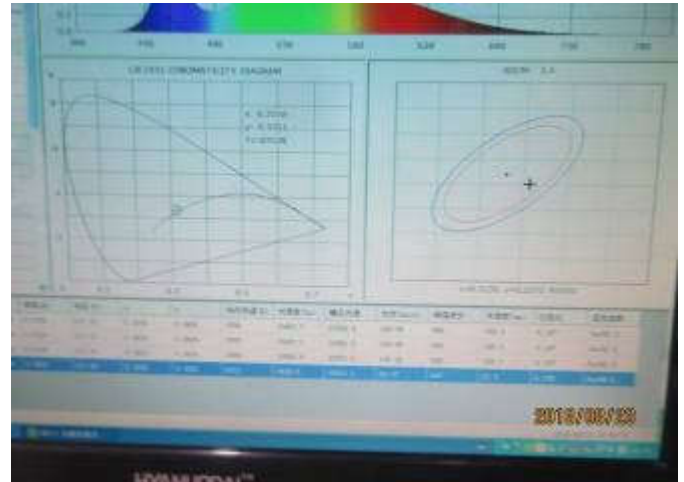

65 R&D department



66 R&D department

3 Workshop



67 R&D department



68 Laser workshop

PLANT EVALUATION REPORT



Report# C-1808221

Continent
Inspection Service Co., Ltd.



69 Laser workshop



70 Laser workshop



71 Laser workshop

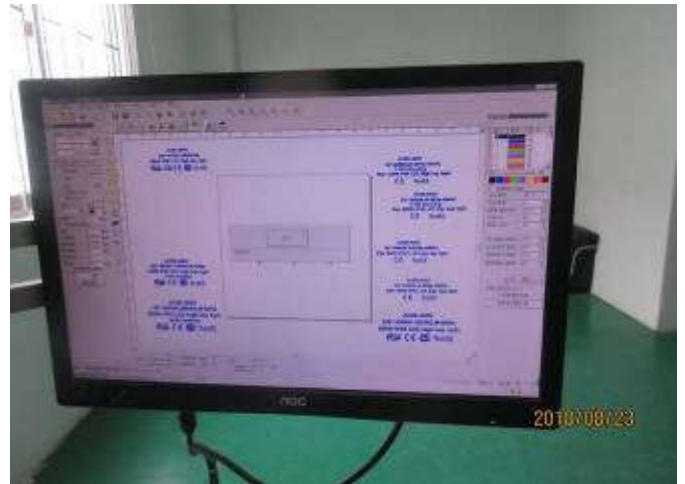

72 Laser workshop



73 Laser workshop



74 Laser workshop

PLANT EVALUATION REPORT



Report# C-1808221

Continent
Inspection Service Co., Ltd.



75 Laser workshop



76 Laser workshop



77 Laser workshop



78 Quality department



79 Quality department



80 Quality department

PLANT EVALUATION REPORT



Report# C-1808221

Continent
Inspection Service Co., Ltd.



81 Quality department



82 Quality department



83 Quality department



84 Quality department



85 Quality department



86 Quality department

PLANT EVALUATION REPORT



Report# C-1808221

Continent
Inspection Service Co., Ltd.



87 Quality department



88 Quality department



89 SMT workshop



90 SMT workshop



91 SMT workshop



92 SMT workshop

PLANT EVALUATION REPORT



Report# C-1808221

Continent
Inspection Service Co., Ltd.



93 SMT workshop



94 SMT workshop



95 SMT workshop



96 SMT workshop



97 SMT workshop



98 SMT workshop

PLANT EVALUATION REPORT



Report# C-1808221

Continent
Inspection Service Co., Ltd.



99 SMT workshop



100 SMT workshop



101 SMT workshop



102 SMT workshop

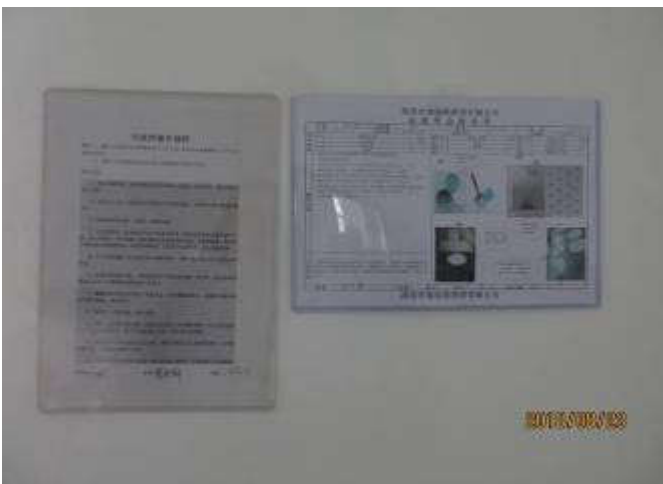

103 SMT workshop



104 SMT workshop

PLANT EVALUATION REPORT



Report# C-1808221

Continent
Inspection Service Co., Ltd.

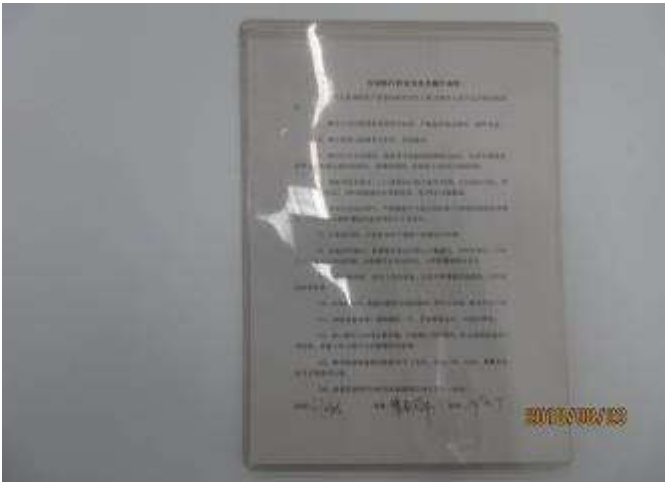

105 SMT workshop



106 Assembly workshop



107 Assembly workshop



108 Assembly workshop



109 Assembly workshop



110 Assembly workshop

PLANT EVALUATION REPORT



Report# C-1808221

Continent
Inspection Service Co., Ltd.



111 Assembly workshop



112 Production line 1



113 Production line 1



114 Production line 1



115 Production line 1



116 Production line 1

PLANT EVALUATION REPORT



Report# C-1808221

Continent
Inspection Service Co., Ltd.



117 Production line 1



118 Production line 1



119 Production line 1



120 Production line 1



121 Production line 1



122 Production line 2

PLANT EVALUATION REPORT



Report# C-1808221

Continent
Inspection Service Co., Ltd.



123 Production line 2



124 Production line 2



125 Production line 2



126 Production line 2



127 Production line 2



128 Production line 2

PLANT EVALUATION REPORT



Report# C-1808221

Continent
Inspection Service Co., Ltd.



129 Defect & repair area



130 Defect & repair area



131 Defect & repair area



132 QC line



133 QC line



134 QC line

PLANT EVALUATION REPORT



Report# C-1808221

Continent
Inspection Service Co., Ltd.



135 QC line



135 Workshop check list



136 QC line



137 Aging test-power on



138 Aging test-power on



139 Aging test-power on